

SET 5/8"R
"TRAV"

SCALE DRAWING

100 S.W. HARNEY ST. #15

CITY OF PORTLAND

MULTNOMAH COUNTY, OREGON

SEPTEMBER 26, 2006

DRAWN BY: MPW CHECKED BY: WGD/III

SCALE 1"=40' ACCOUNT #150-5466

M:\PROJECTS\MCDONALD-5466\MCDONALD-SC

Centerline Concepts Inc.



700 MOLATA AVENUE, OREGON CITY, OREGON 97045
503 650-0188 FAX 503 650-0189

● = PILING FIELD
MEASURED AT CENTER
OF PILING
X=---
Y=---

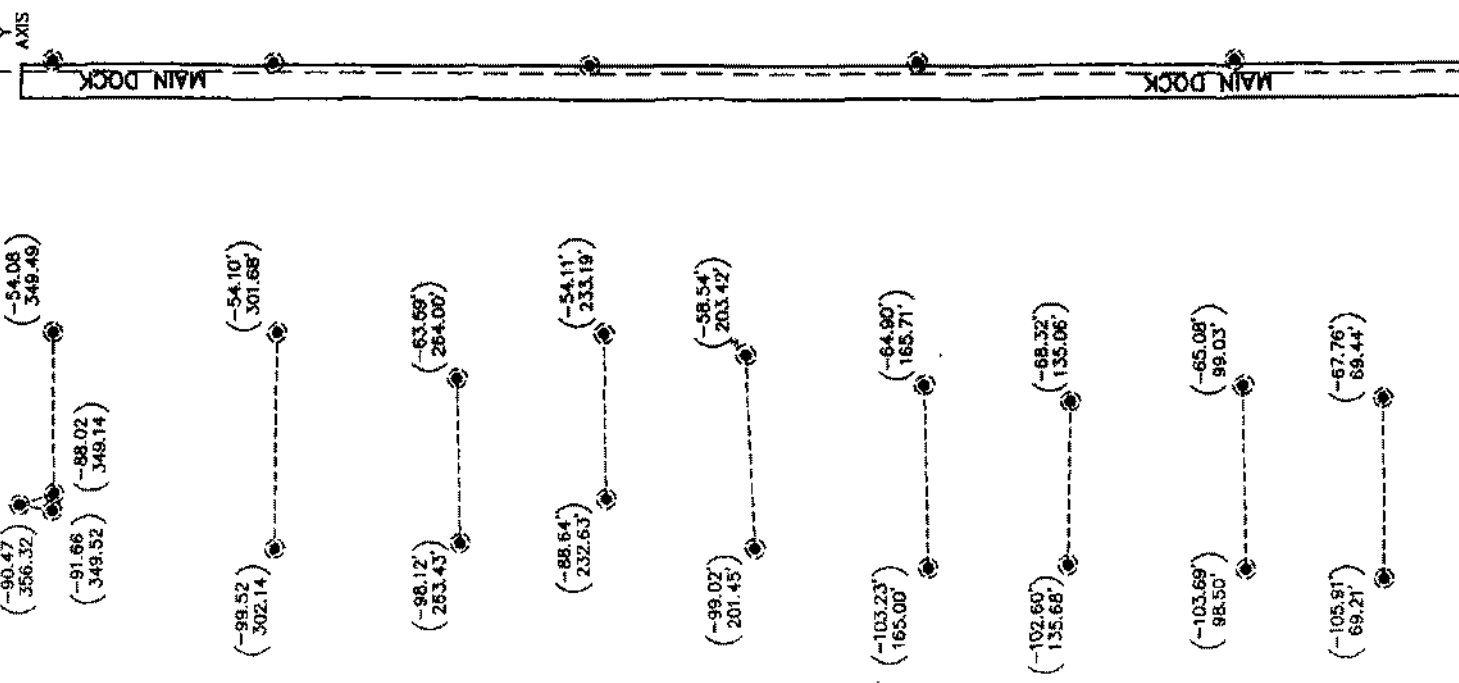
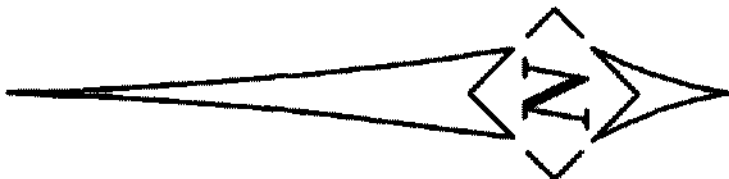

IPS

SET 5/8" TRAY

SCALE DRAWING

100 S.W. HARNEY ST. #15

CITY OF PORTLAND

MULTNOMAH COUNTY, OREGON

SEPTEMBER 26, 2006

DRAWN BY: MPW CHECKED BY: WGDIII

SCALE 1"=40' ACCOUNT #150-5466

M:\PROJECTS\MCDONALD-5466\MCDONALD-SC

Centerline Concepts Inc.



700 MOLALLA AVENUE, OREGON CITY, OREGON 97045
503 650-0188 FAX 503 650-0189

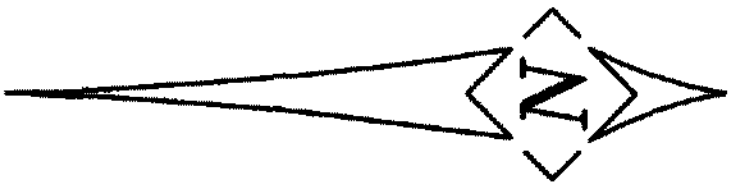

⊙ = PILING FIELD
MEASURED AT CENTER
OF PILING
X-----
Y-----

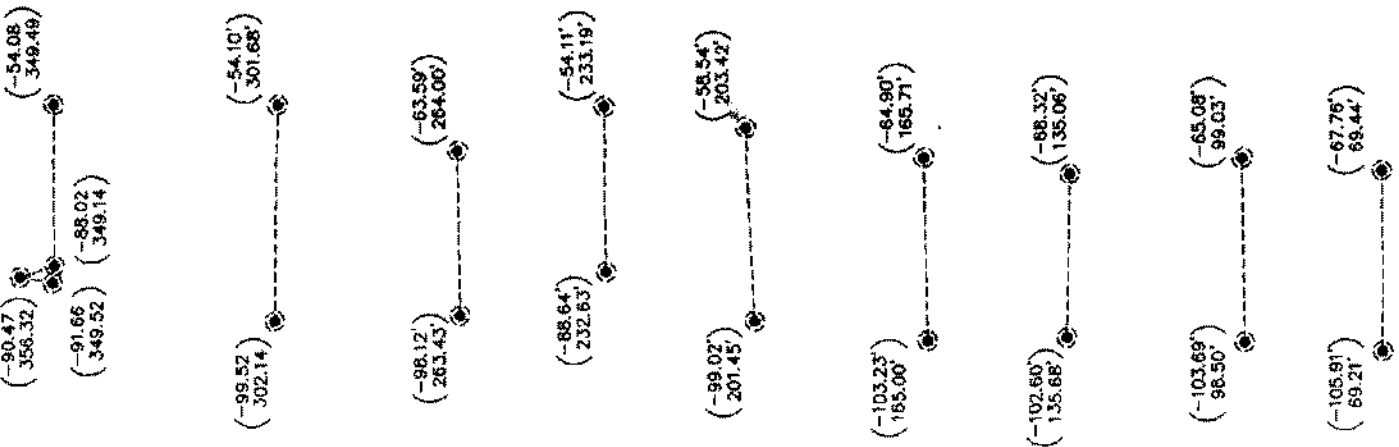
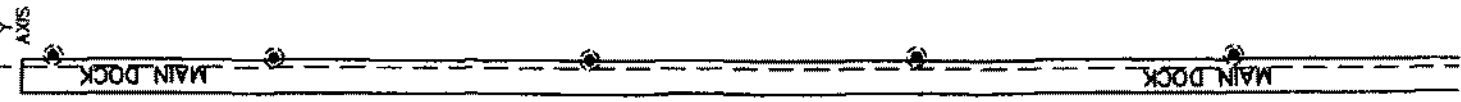

SP

FLOATING HOME

X
AXIS

(-105.01'
36.62')

(-68.43'
57.33')

(-104.81'
5.54')

(-69.27'
4.84')

(-105.76'
-28.17')

(-56.07'
-26.65')

(-106.98'
-56.60')

(-74.69'
-57.45')

(-108.08'
-88.42')

(-74.55'
-89.49')

(-107.52'
-119.19')

(-78.35'
-120.81')

(-109.45'
-152.21')

(-76.98'
-153.42')

(-99.18'
-184.82')

(-55.67'
-186.46')

(-107.70'
-219.36')

(-89.24'
-220.93')

SET SCRIBE
(0.00'
0.00')
ORIGIN OF
COORDINATES

RAMP

GANG PLANK

MAIN DOCK

MAIN DOCK

APPROXIMATE TOP OF BANK

PARKING LOT

SET 5/8" IR
"TRAV"

SET 5/8" IR
"TRAV"